

WRITE BRAIN

For students K-12

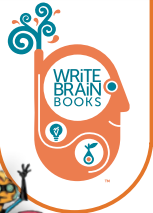

PROUD CONFERENCE SPONSOR!

STANDARDS-ALIGNED NARRATIVE & CREATIVE WRITING PROGRAMS FOR MULTILINGUAL LEARNERS K-12. EVERY STUDENT BECOMES A PUBLISHED AUTHOR!

Every ELD Proficiency Level:

Newcomer

Expanding

Emerging

Bridging

Students Can Write In Any Language!

Writing

Reading

Listening

Speaking



VISIT OUR BOOTH FOR FUN FREEBIES!

CONTACT US: 1.855.WB.BOOKS

@WriteBrainBooks

WriteBrainBooks.com
eduprogram@WriteBrainBooks.com



PLACE | Professional Learning
and Community Education
SCHOOL OF EDUCATION
UNIVERSITY OF WISCONSIN-MADISON



2019

LITERACY BY THE LAKES



Making literacy education meaningful

AUGUST 9-10

reading | writing | making



DAY 1 SCHEDULE

LOCATION: ALUMNI LOUNGE

8:00 AM - 9:00 AM

Registration/Check-in

Breakfast provided

LOCATION: LEE LOUNGE

8:00 AM

Exhibit Hall open

LOCATION: ALUMNI LOUNGE

9:00 AM - 9:30 AM

Opening

LOCATION: TBA

9:30 AM - 11:00 AM

Large Group Introductory Session

All strands: reading, writing, making

LOCATION: LEE LOUNGE

11:00 AM - 11:15 AM

Break

LOCATIONS: TBA

11:15 AM - 12:15 PM

Strand specific breakout sessions

LOCATION: ALUMNI LOUNGE

12:15 PM - 1:15 PM

Lunch

Presentation by our literacy partner and lunch sponsor, WRiTE BRAiN Books

AUGUST 9 - 10, 2019

LOCATIONS: TBA

1:15 PM - 2:15 PM

Strand specific breakout sessions

LOCATION: LEE LOUNGE

2:15 PM - 2:30 PM

Break

LOCATION: ALUMNI LOUNGE

2:30 PM - 3:15 PM

New Books for Children and Teens about Race and Social Justice

CCBC Director KT Horning will highlight a selection of recommended books from 2018-19 that deal with issues of race, class, dis/ability, gender, sexuality, and the fight for social justice.

LOCATIONS: TBA

3:15 PM - 4:00 PM

Strand specific breakout sessions

4:15 PM **Exhibit hall closes**

LOCATION: LAKESIDE TERRACE, MEMORIAL UNION

4:15 PM

Terrace Time

Optional, but very fun!

DAY 2 SCHEDULE

LOCATION: ALUMNI LOUNGE

8:00 AM - 9:00 AM

Breakfast

LOCATION: LEE LOUNGE

8:00 AM

Exhibit Hall open



LOCATIONS: TBA

9:00 AM - 10:30 AM

Strand specific breakout sessions

LOCATION: LEE LOUNGE

10:30 AM - 10:45 AM

Break

LOCATION: ALUMNI LOUNGE

10:45 AM - 11:45 AM

Keynote: Gloria Ladson-Billings

LOCATION: ALUMNI LOUNGE

11:45 AM - 12:30 PM

Lunch

LOCATIONS: TBA

12:30 PM - 2:00 PM

Strand specific breakout sessions

LOCATION: LEE LOUNGE

2:00 PM - 2:15 PM

Break

2:15PM Exhibit hall closes

LOCATIONS: TBA

2:15 PM - 3:15 PM

Strand specific breakout sessions

3:15PM Adjourned

OUR KEYNOTE SPEAKER



Gloria Ladson-Billings is the former Kellner Family Distinguished Professor of Urban Education in the Department of Curriculum and Instruction and faculty affiliate in the Department of Educational Policy Studies at the University of Wisconsin–Madison. She was the 2005-2006 president of the American Educational Research Association (AERA). Ladson-Billings' research examines the pedagogical practices of teachers who are successful with African American students. She also investigates Critical Race Theory applications to education. She is the author of the critically acclaimed books *The Dreamkeepers: Successful Teachers of African American Children* and *Crossing Over to Canaan: The Journey of New Teachers in Diverse Classrooms*, and numerous journal articles and book chapters. She is the former editor of the American Educational Research Journal and a member of several editorial boards. Her work has won numerous scholarly awards including the H.I. Romnes Faculty Fellowship, the NAEd/Spencer Postdoctoral Fellowship, and the Palmer O. Johnson outstanding research award. During the 2003-2004 academic year, she was a fellow at the Center for Advanced Study in the Behavioral Sciences at Stanford University. In fall of 2004, she received the George and Louise Spindler Award from the Council on Anthropology and Education for significant and ongoing contributions to the field of educational anthropology. She holds honorary degrees from Umeå University (Umeå, Sweden), University of Massachusetts-Lowell, the University of Alicante (Alicante, Spain), the Erickson Institute (Chicago), and Morgan State University (Baltimore). She is a 2018 recipient of the AERA Distinguished Research Award, and she was elected to the American Academy of Arts & Sciences in 2018.

PRESENTERS



Dawnene D. Hassett is a professor in the literacy area of the Department of Curriculum & Instruction at University of Wisconsin–Madison. She researches the foundational roles of play and imagination in early literacy education, and she studies how children read and write complex and visually interactive texts. She sees literacy as a process of making meaning through written, visual, and oral language, and she promotes reading and writing pedagogies that support, respect, and truly love students of all ages for the

meaning-makers they are. Professor Hassett also directs the Wisconsin State Reading Teacher and Reading Specialist License Programs for expert literacy teachers. She was an elementary school teacher (grades K, 1, & 3) and a reading specialist (pre-K-12) for 13 years. She received her PhD in Curriculum Theory from the University of Wisconsin–Madison.



Peter Wardrip is an Assistant Professor of STEAM Education at the University of Wisconsin–Madison. His research focuses on informal/formal learning collaborations, professional learning for educators, formative assessment and making as a learning process. Peter grew up in Racine, WI and enjoys playing soccer, euchre and drinking hot cocoa with his family.



Mark was an elementary and middle school teacher in Colorado and Wisconsin. He also taught a methods course and supervised student teachers in the University of Wisconsin–Madison Elementary Education program.



Previously, she co-founded and taught high school English at Clark Street Community School in Middleton, WI. Bryn studied Literacy and English at University of Wisconsin–Madison where she earned her BA and MS. Much of her work in education has focused on equitable and innovative environments.



Kate E. Vieira is an educator, researcher, and writer at the University of Wisconsin–Madison. Her work is devoted to promoting educational equity and international understanding. Her research spans the United States, Latin America, and Eastern Europe, where she works with immigrants, transnational families, and community organizations. One central question drives her research and teaching: *what are the consequences of writing for the lives of ordinary people across the globe?*

PYLE CENTER MAP

First Level

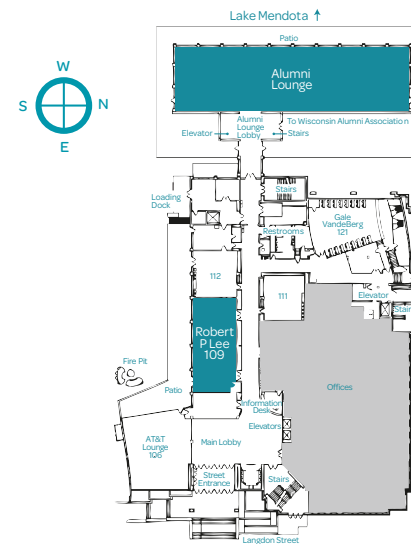

THANK YOU TO OUR SPONSORS



School of Education
UNIVERSITY OF WISCONSIN–MADISON